

So. Carolina Pursuant to a warrant from (260)

John Thomas Esq. Com. Ld. Dated the 5<sup>th</sup> Aug. 1793  
 I have Admeasured & laid out unto James Brown  
 a tract of Nine Hundredth Ninety acres of Land  
 Situate in Pinkney District. Spartanburg  
 County on the Edge Between Paculate River  
 & Truckley Creek Bounded on the NW by David  
 Jones's Land, SW by James Browns Land East  
 by Evan Davis's Land, & hath such shape & marks  
 & Buttines & Boundings as the above plat represents

Surveyed the 6<sup>th</sup> Aug. 1793

John C. Connell Esq.

Readed 25<sup>th</sup> Aug. 1793  
 Del. John C. Connell

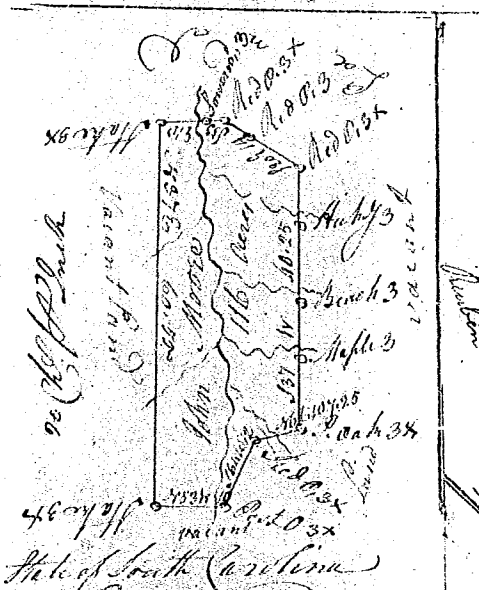

State of South Carolina

Pursuant to a warrant from

John Thomas Esq. Com. Ld. Dated the 22<sup>nd</sup> Day  
 of Aug. 1793. I have Admeasured & laid

out unto John Meier a tract of One Hundred  
 & Sixty Acres of Land, Situate in Greenville

County on both sides Burrows's Creek of the middle part of Saluda River  
 near the head of said Creek. I hath such shape & marks as the above plat  
 represents. Surveyed the 23<sup>rd</sup> Aug. 1793

George Salmon Esq.

Readed 9<sup>th</sup> Nov. 1793. Sec'd

So. Carolina Pursuant to a warrant from John  
 Thomas Esq. Com. Ld. No. of Saluda Dated  
 the 24<sup>th</sup> Oct. 1793. I have Admeasured & laid  
 out unto Albert Middleton, a tract of One  
 Hundred Acres of Land Situate in Greenville  
 County on a branch of Saluda River - Bounded  
 on one side by the said Robert  
 Middletons Land and hath such shape &  
 marks as the above plat represents

Certified the 2<sup>nd</sup> Novem. 1793 James Galt D.

129

Readed the 9<sup>th</sup> Nov. 1793

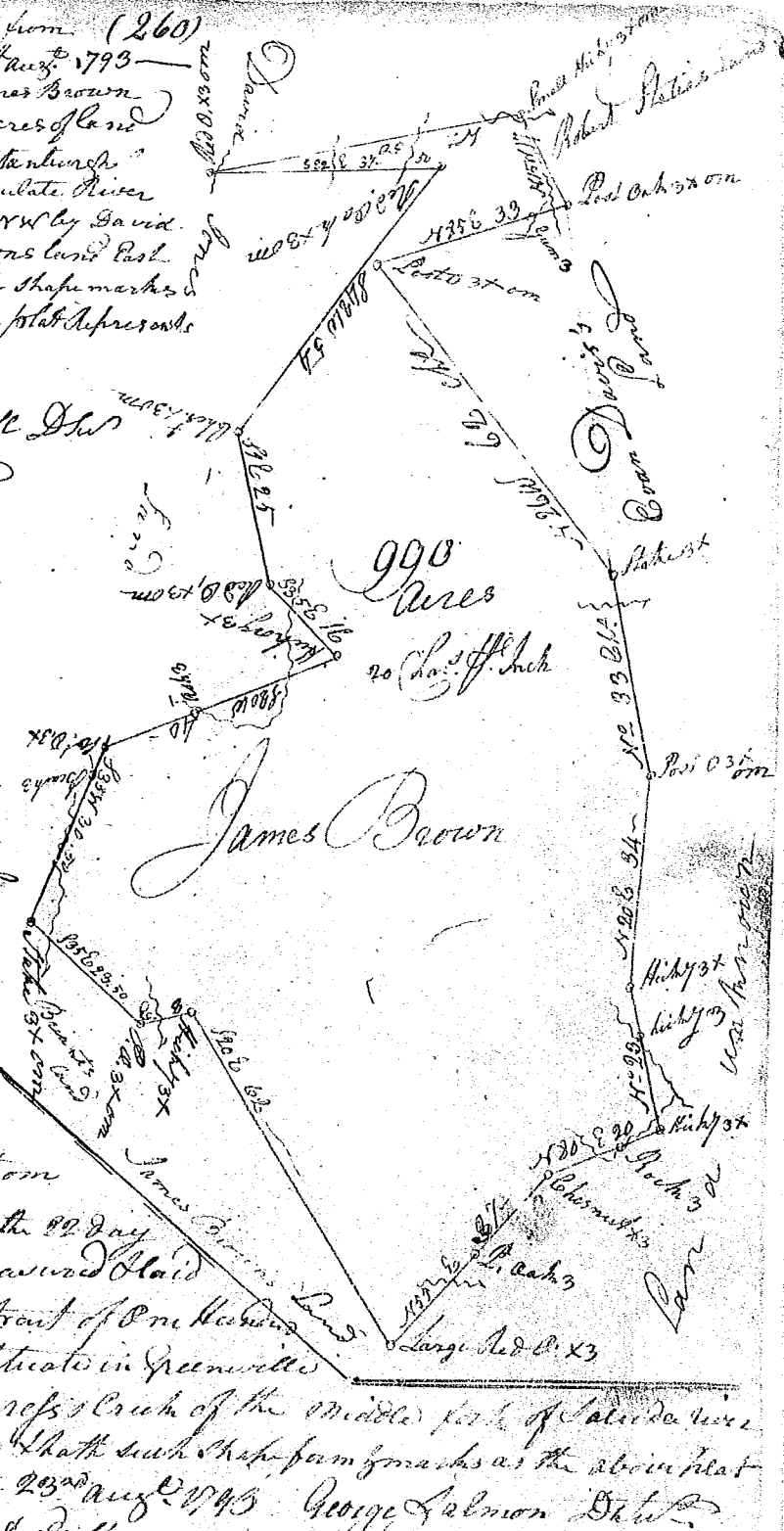

James Brown

990 Acres  
 20 Ch. off Inch

Large Ad. L. 23

1793

1793

1793

1793

1793

1793

1793